

SF40

SuperFOIL Insulation

Thermal Insulation for use in Roofs and Partition Walls

INSTALLATION GUIDELINES & DATASHEET

SF40 SuperFOIL can be installed over or under the rafter and provides continuous insulation. It is ideal for roofs and attic conversions.

Over Rafter Application - Warm Roof

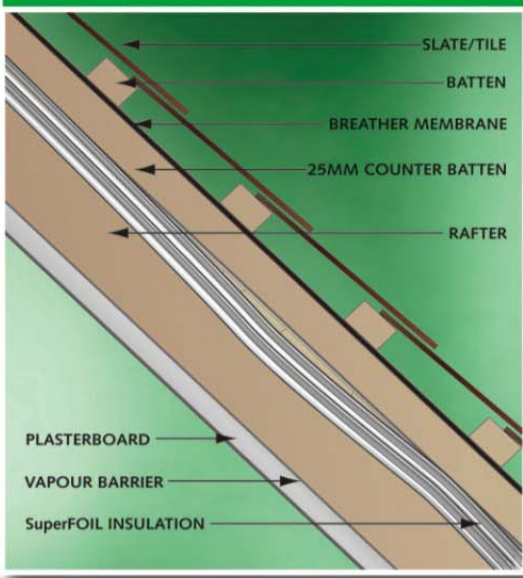

Over Rafter Application

- Roll out SF40 SuperFOIL over rafters. Staple every 50mm and cover joints with SF40 SuperFOIL tape, overlap widths 75mm.
- At the eaves cut quilt around rafters and seal to cavity wall insulation or wall plate to create airtight envelope.
- Fix battens parallel with the rafters and apply breathable roof underlay according to manufacturers guidelines.
- Fix roofing tiles

Under Rafter Application - Cold Roof

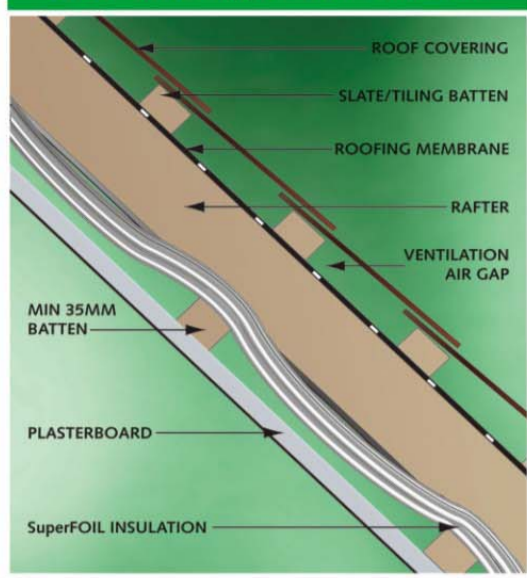

Under Rafter Application

- Roll out SuperFOIL, starting along the top of the roof. Batten horizontally over rafters. Staple every 50mm and cover joints with SF40 SuperFOIL tape, overlap widths 75mm.
- At the bottom of the roof pitch, staple the SF40 SuperFOIL directly onto the timber wall plate to create airtight envelope.
- Fix battens across the rafters and ensure 25mm air gap between quilt and the plasterboard.

NB Use sarking board in Scotland

NB Use sarking board in Scotland

	Construction	Thickness (mm)	Thermal Conductivity (W/mK)	Thermal Resistance (m ² K/W)
Conventional R Value	Outside Surface Resistance	-	-	0.100
	Tiles	10mm	-	0.000
	Tile Battens	22mm	-	0.000
	Breather Membrane	1mm	-	0.000
	Battens	38mm	-	0.000
	SF40 SuperFOIL	60mm	-	3.564
	Polyurethane between rafters	25mm	-	1.000
	Rafters	150mm	-	0.000
	Plasterboard	13mm	0.190	0.066
	Inside Surface Resistance	-	-	0.100
	U-VALUE, Combined method: 0.2025/m ² K (0.20) (lower limit = 4.825 m ² K/W, upper limit = 5.052m ² K/W)			
Comparative R Value	Outside Surface Resistance	-	-	0.100
	Tiles	10mm	-	0.000
	Tile Battens	22mm	-	0.000
	Breather Membrane	1mm	-	0.000
	Battens	38mm	-	0.000
	SF40 SuperFOIL	60mm	-	9.600
	Rafters	150mm	-	0.000
	Plasterboard	13mm	0.190	0.066
	Inside Surface Resistance	-	-	0.100
	U-VALUE, Combined method: 0.0980/m ² K (0.10) (lower limit = 10.205 m ² K/W, upper limit = 10.205m ² K/W)			

	Construction	Thickness (mm)	Thermal Conductivity (W/mK)	Thermal Resistance (m ² K/W)
Conventional R Value	Outside Surface Resistance	-	-	0.100
	Tiles	10mm	-	0.000
	Tile Battens	22mm	-	0.000
	Breather Membrane	1mm	-	0.000
	Rafters	100mm	-	0.000
	Polyurethane between rafters	25mm	-	1.000
	SF40 SuperFOIL	60mm	-	3.564
	Battens	38mm	-	0.000
	Plasterboard	13mm	0.190	0.066
	Inside Surface Resistance	-	-	0.100
	U-VALUE, Combined method: 0.1886W/m ² K (0.19) (lower limit = 5.294m ² K/W, upper limit = 5.310m ² K/W)			
Comparative R Value	Outside Surface Resistance	-	-	0.100
	Tiles	10mm	-	0.000
	Tile Battens	22mm	-	0.000
	Breather Membrane	1mm	-	0.000
	Rafters	100mm	-	0.000
	SF40 SuperFOIL	60mm	-	9.600
	Battens	38mm	-	0.000
	Plasterboard	13mm	0.190	0.066
	Inside Surface Resistance	-	-	0.100
	U-VALUE, Combined method: 0.0983/m ² K (0.10) (lower limit = 10.170 m ² K/W, upper limit = 10.186 m ² K/W)			

SF40 SuperFOIL Insulation

INDEPENDENTLY TESTED & CERTIFIED TO INTERNATIONAL STANDARDS
Conventional R Value **3.564**

Installation Guide

- SF40 SuperFOIL can be used in all types of roof.
- SF40 SuperFOIL can be laid horizontally or vertically depending on the characteristics of the area to be insulated.
- SF40 SuperFOIL can be cut with a craft knife or scissors.
- Attach with galvanised or stainless steel staples. (20mm min).
- Contact with lead, copper and its alloys should be avoided.
- Do not use SF40 SuperFOIL to insulate a chimney flue.
- When using SF40 SuperFOIL around downlighters a 30mm clear cavity must be provided.
- SF40 SuperFOIL is most effective with a 25mm minimum air gap easily provided with battens.
- SF40 SuperFOIL should be stored under cover and protected from the elements.
- SF40 SuperFOIL tape (20m x 100mm) to be used on all overlaps and joints.
- Be careful of the sun's reflection when using outside.

Distinctive Features

- SF40 SuperFOIL is the thickest foil insulation of its type in the UK.
- SF40 SuperFOIL has a manufacturer certified conventional R Value of 3.564 and a comparative R Value of 9.6.
- SF40 SuperFOIL's extra large roll size of 15m² reduces waste.
- SF40 SuperFOIL can be used in conjunction with any other form of insulation to 'Super Insulate'.
- SF40 SuperFOIL is lightweight and easy to handle.
- SF40 SuperFOIL delivers maximum insulation from the use of a minimum amount of space.

TECHNICAL SPECIFICATIONS

DESCRIPTION	LAYERS
POLYPROPYLENE REINFORCED HEAVY OUTER LAMINATED FOIL	2
ALUMINIUM MYLAR COATED REFLECTIVE FOIL LAYERS	12
THERMO FOAM SEPARATION LAYERS	16
LOFT QUILT 80G/SQM LAYERS	6
TOTAL LAYERS	36
PACKING	142 Poly Tube
CONVENTIONAL R VALUE	3.564
COMPARATIVE R VALUE	9.6
THICKNESS INSTALLED	60mm
WEIGHT	16.5kg
DIMENSIONS PACKED	1.5m by 500mm
ROLL DIMENSIONS	1.5m by 10m

